

REV	ECN NO.	DESCRIPTION	DATE	DESIGN
D	NAE09052	新增PA66无卤料号. (X/D)	03/25/09'	姜军广
E		变更料号	11/04/09'	蓝荣梅

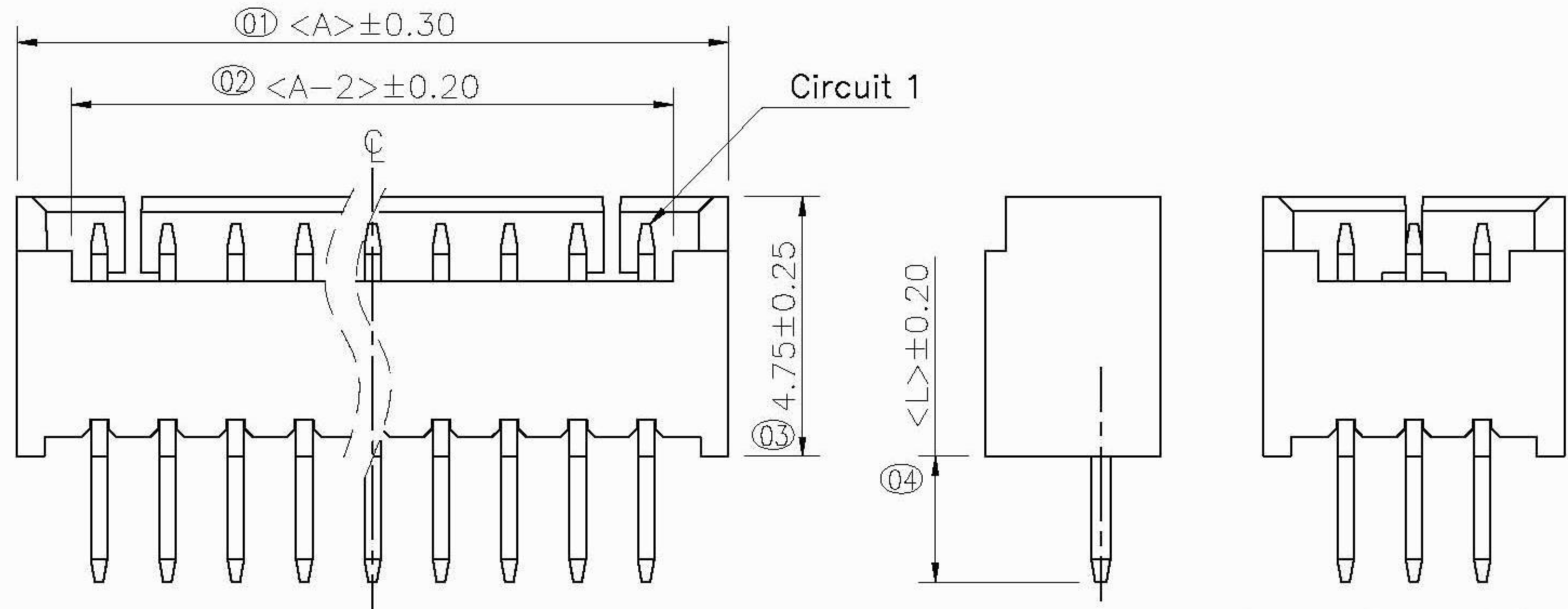

NOTES:
 CURRENT RATING: 1A AC/DC
 VOLTAGE RATING: 125V AC/DC
 TEMPERATURE RANGE: -25°C~+85°C
 CONTACT RESISTANCE: 20m Ω MAX
 INSULATION RESISTANCE: 500M Ω MIN
 WITHSTANDING VOLTAGE: 500V AC/MINUTE

(2~3pin的只有一个缺口在中间)
 (如上图示)

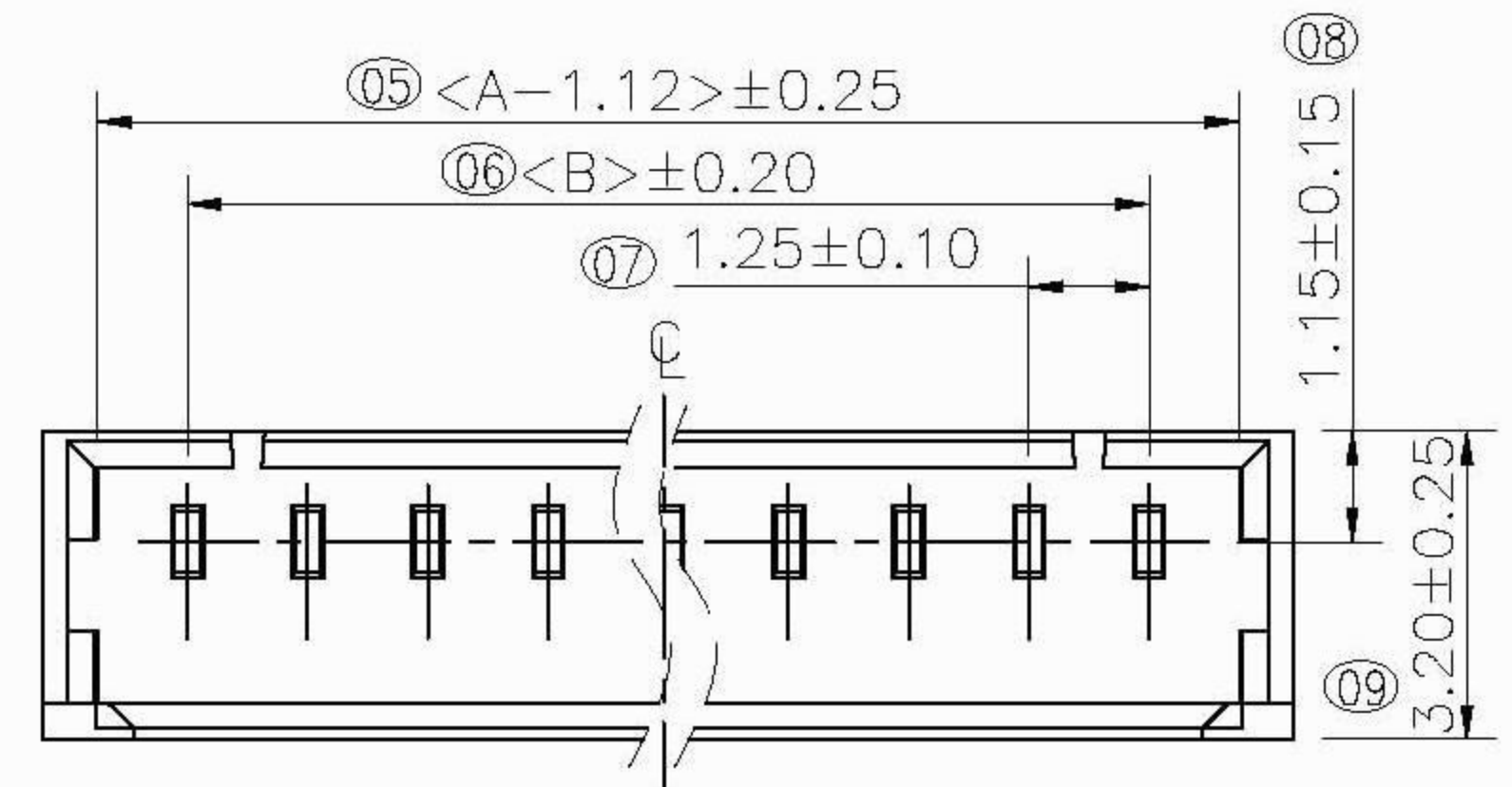

Recommended P.C.B Layout (Top Side)
 (Tolerance = ± 0.05)

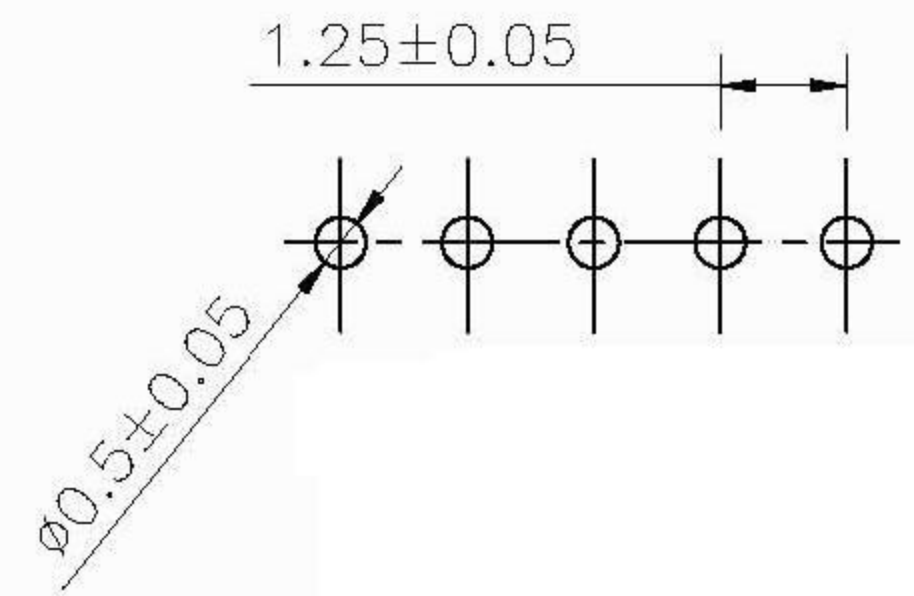

PART NO.	Dimensions	
	A	B
WF1250S02	4.25	1.25
WF1250S03	5.50	2.50
WF1250S04	6.75	3.75
WF1250S05	8.00	5.00
WF1250S06	9.25	6.25
WF1250S07	10.50	7.50
WF1250S08	11.75	8.75
WF1250S09	13.00	10.00
WF1250S10	14.25	11.25
WF1250S11	15.50	12.50
WF1250S12	16.75	13.75
WF1250S13	18.00	15.00
WF1250S14	19.25	16.25
WF1250S15	20.50	17.50
WF1250S16	21.75	18.75

共用件 Wafer-T	A1250TVHB000	BRASS T=0.30	NI: 30-60u"MIN; SN: 70-120u"MIN
Wafer-胶芯	A1250DPXX3	PA9T UL 94V-0	本色
Wafer-胶芯	A1250DPXX3	PA66 UL 94V-0	无卤本色
Wafer-胶芯	A1250DPXX2	PA66+30%GF UL 94V-0	无卤本色
Wafer-胶芯	A1250DPXX1	PA66+30%GF UL 94V-0	本色
Wafer-胶芯	A1250DPXX0	PA6T UL 94V-0	本色
Wafer-胶芯	A1250DPXX6	PA6T UL 94V-0	无卤本色
PART NAME	PART No.	MATERIALS	SPEC

DIM	TOL	DIM	TOL
X.	/	X°	/
X.X	±0.25	X.X°	±2°
X.XX	±0.20	X.XX°	±1°
X.XXX	±0.10	X.XXX°	/

GXCON ENTERPRISE CO., LTD

DRAW NO.	DATE	P/N NO:	DRAW NAME:
DESIGN:		WF1250SXX	MX 1.25 180° DIP Wafer
CHECK:			
REVIEW:		REV. E	SCALE 1:1
		UNIT: mm	SHEET: 1 OF 1